

ARDEN & WAY

BLOCK MANAGEMENT & LETTINGS



188 -190 Sea Front

, Hayling Island, PO11 9HT

£2,000

Arden & Way are pleased to present to the lettings market this three bedroom penthouse apartment. These modern apartments are located just across the road from Hayling Islands beautiful beaches. Recently constructed by the well established company Alpine Homes these apartments are built to a high specification.

Apartment 18 is located on the first floor and comprises of an open plan sitting room/kitchen with bifold doors onto the balcony, a master bedroom with an en-suite, two further bedrooms which share a balcony and a spacious bathroom.

This property has well maintained communal gardens and two off road parking spaces. Don't miss the chance to view this apartments. Please call or email for more information or to book a viewing.

- New Build
- Sea Views
- Large Open Plan Living Area
- 3 Bedrooms
- 2 Allocated Parking Spaces

Viewing

Please contact our Arden & Way Office on 02392 460 899 if you wish to arrange a viewing appointment for this property or require further information.



3



2



1



B

Floor Plan

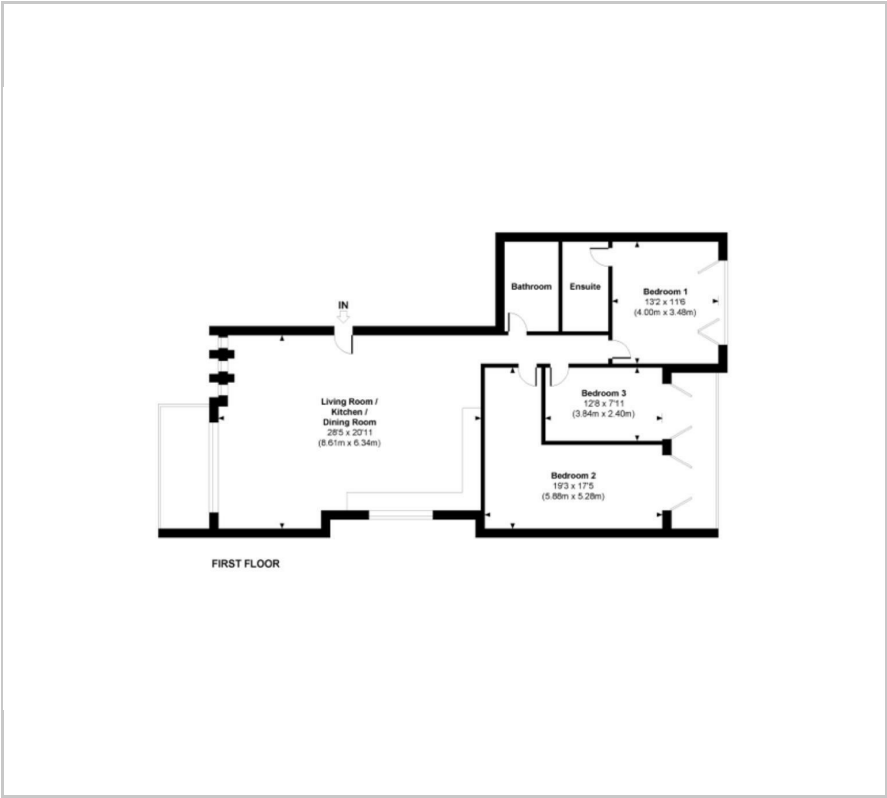

Area Map



Energy Efficiency Graph

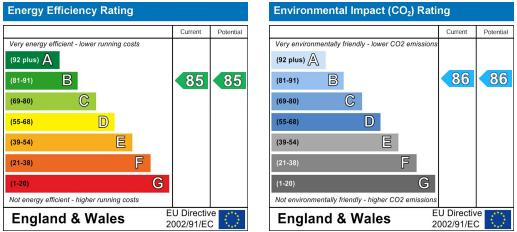

These particulars, whilst believed to be accurate are set out as a general outline only for guidance and do not constitute any part of an offer or contract. Intending purchasers should not rely on them as statements of representation of fact, but must satisfy themselves by inspection or otherwise as to their accuracy. No person in this firms employment has the authority to make or give any representation or warranty in respect of the property.

120 Elm Grove, Hayling Island, Hampshire, PO11 9EH

Tel: 02392 460 899 Email: info@ardenway.co.uk www.ardenway.co.uk